

PILASTRO N. 2

INCAMICIATURA PILASTRI

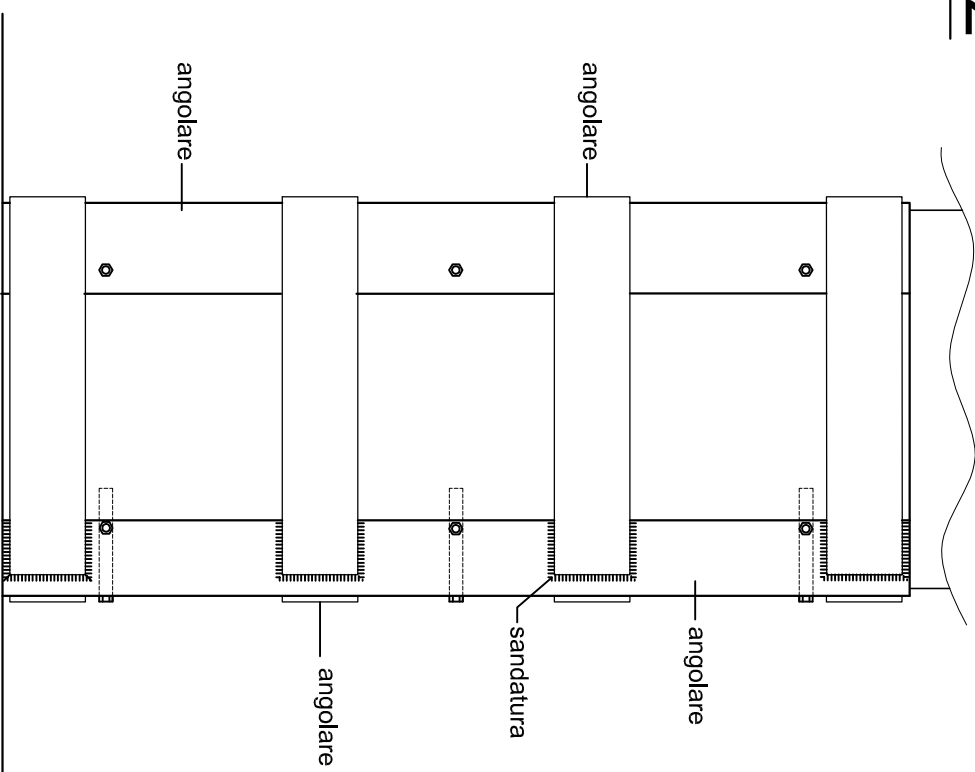

COLLEGAMENTO FRA TRAVI PRINCIPALI E PILASTRI

In questo particolare collegamento si è deciso di utilizzare piastre in acciaio S 235, bulloni M16 (classe 8.8) con barre passanti di 20 mm di diametro (classe 8.8).

Tamponi in materiale plastico ad alta resistenza 200x200 mm x (spessore da rilevare)

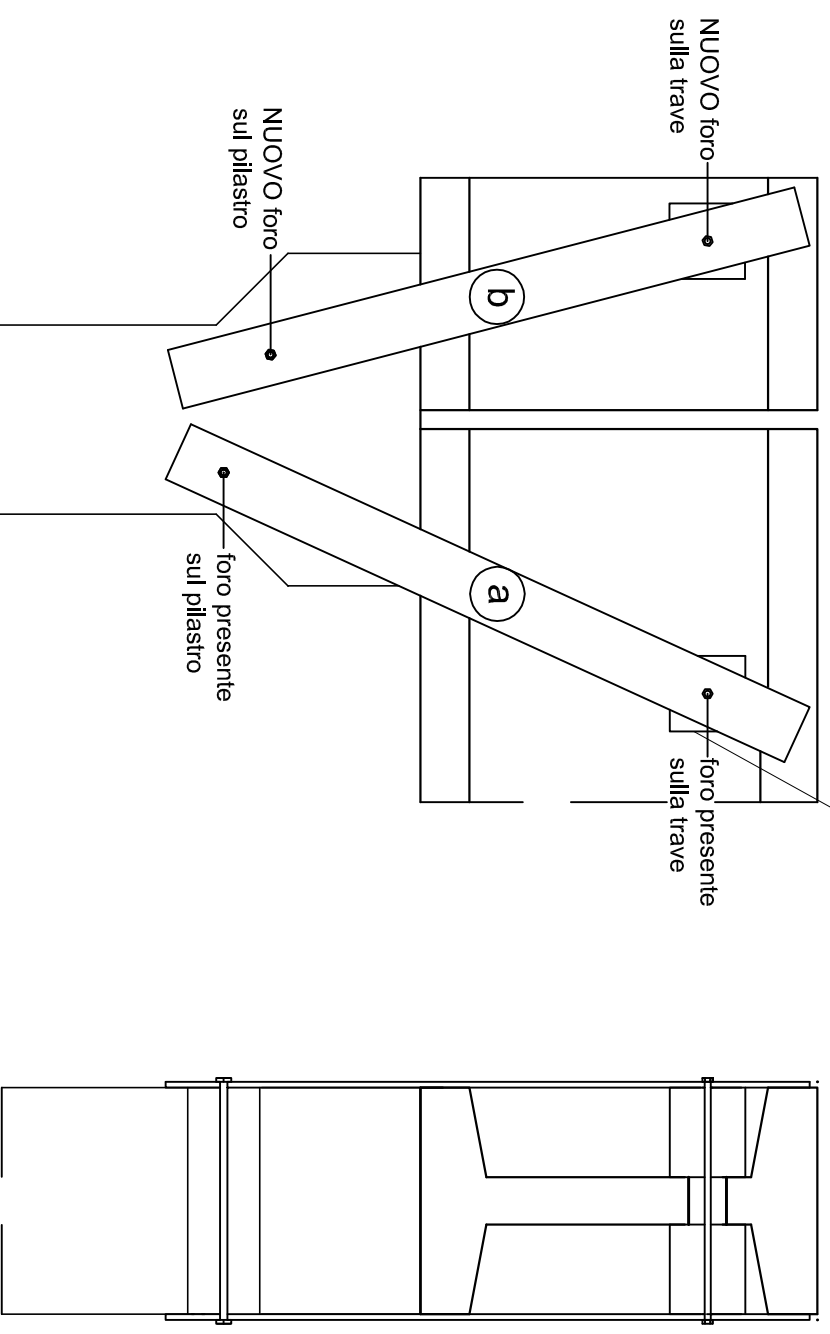

STATO ATTUALE

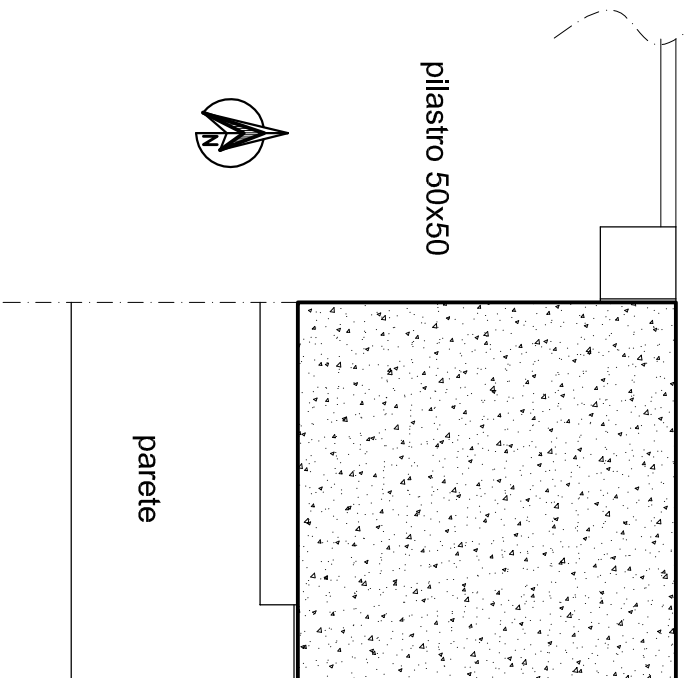

PALAZZINI LABORATORI

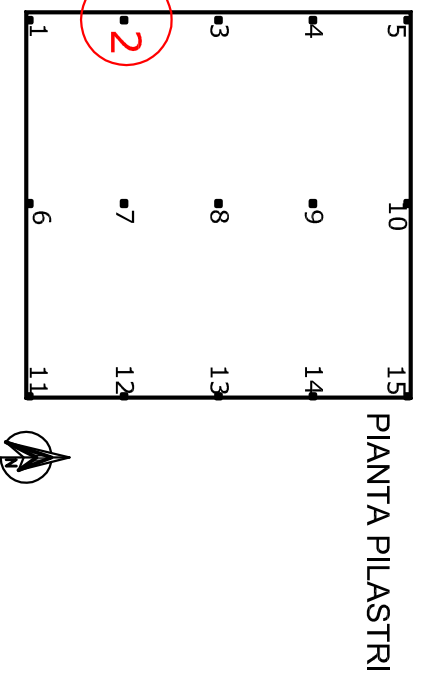

N. 4 ANGOLARI
500x500x8xh100

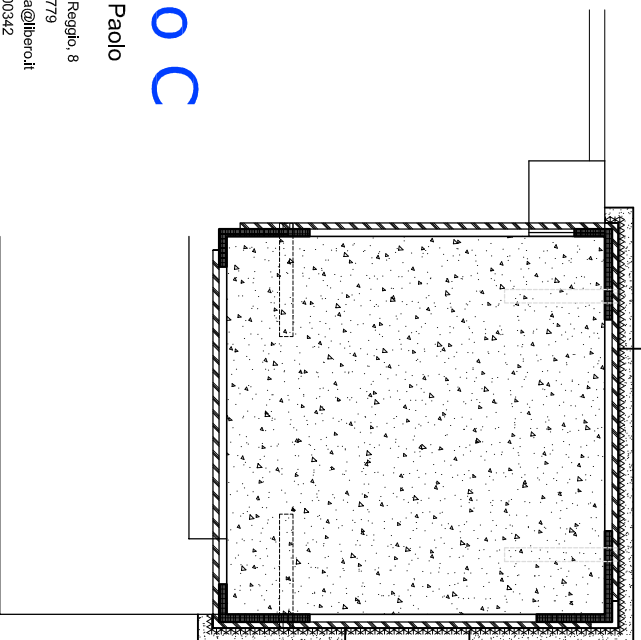

N. 4 ANGOLARI
500x500x8xh100

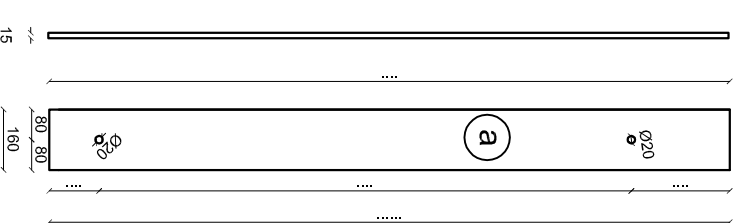
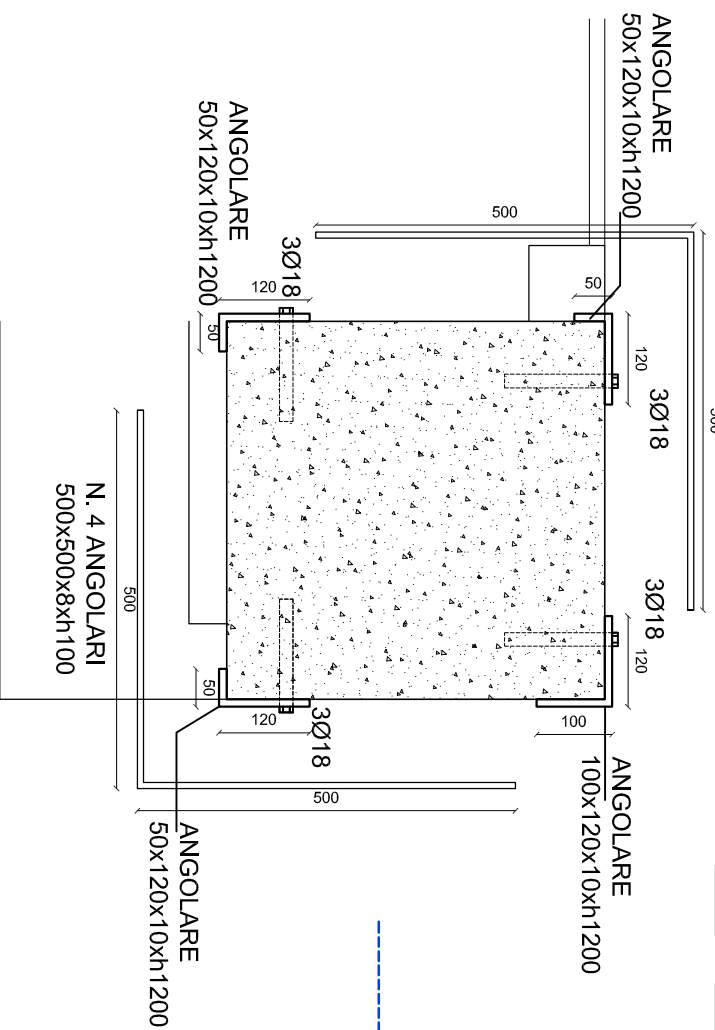

LUNGHEZZE
DA
VERIFICARE

Studio C

di Ing. Chierici Paolo

43126 Parma - Via Reggio, 8
Tel. 0521.782779
E-mail: studiocparma@libero.it
P. IVA 02733800342